

# TYPE LR400200H

## Dimensions

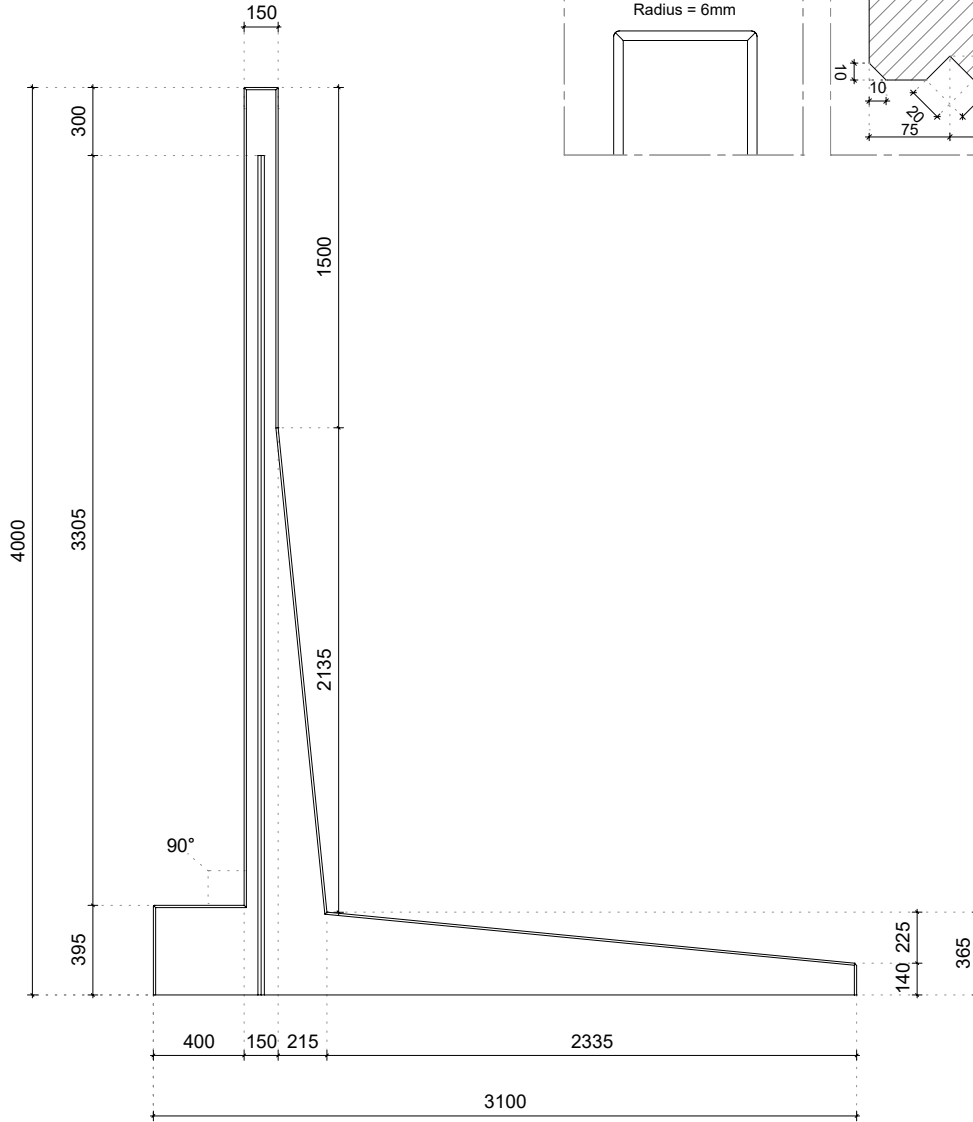

## Details

### Rounded top edge

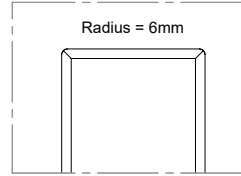

### Groove for joining strip

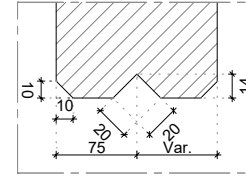

### Element connection

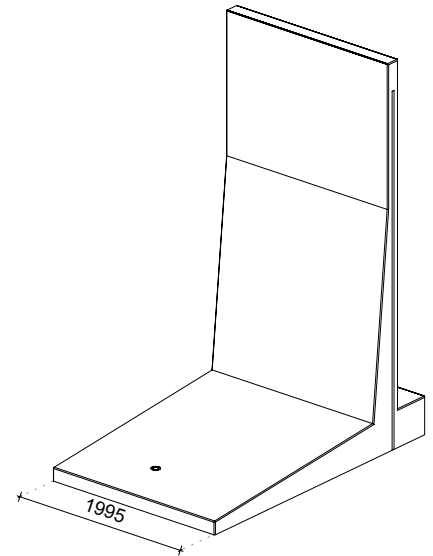
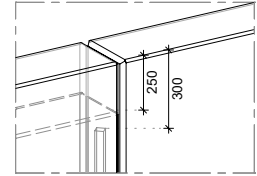

## Technical details

|                         |   |
|-------------------------|---|
| Concrete mixture        | 2nd Generation self-compacting C60/75     |
| Reinforcement steel     | B500                                      |
| Weight                  | 8076kg (L = 1995mm)                       |
| Concrete cover          | 45mm                                      |
| Dimensional tolerance   | +/- 5mm                                   |
| Concrete surface finish | All visible sides class A (B1 on request) |
| Design life             | 100 years                                 |
| Product warranty        | 10 years                                  |
| Environmental class     | XA3, XC4, XD3, XS3, XF4                   |
| Hoisting device         | Ball head anchor 10 tons                  |

## Constructed according to

|                    |                          |
|--------------------|--------------------------|
| EN 1990 Eurocode 0 | EN 206                   |
| EN 1991 Eurocode 1 | Incl. national addendums |
| EN 1992 Eurocode 2 |                          |
| EN 1997 Eurocode 7 |                          |

## Produced method



Energy  
neutral



Filtered  
rainwater



Sustainable raw  
materials



Recyclable  
materials

## Certification

